

Portable Navigation Device

PN 2050

Product Information



Start screen

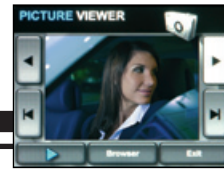

Picture viewer

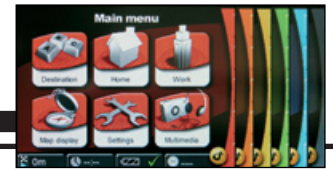

Multiple color settings



* Optional

- 3.5" Touch Screen Display (TFT LCD)
- Integrated GPS Receiver
- ZIP Code Entry
- Antiglare Coating to reduce Reflection
- Customizable infobar
- Automatic Display Brightness Control

- Built-in 64 MB Flash Memory
- Removable/Rechargeable Li-Ion Battery
- SD Card Slot
- MP3 Player
- JPEG Viewer
- 5 Route Criteria
- 4 Route Criteria Options

- Stereo Headphone Out
- IR Receiver for Remote Control
- Route & Sound
- 2D/3D Map view
- Position Independent Route Planning
- Multiple color settings
- Two integrated games: Sudoku and Block cracker

Enhanced Route & Sound with Car Radio

Route & Sound enables listening to MP3-files whilst being navigated to the selected destination via voice, pictogram and map guidance. Therefore the PN 2050 is equipped with a 3.5 mm stereo jack to access an audio signal. Hence, navigation indications and the sound of MP3-files can be transmitted to the cars entertainment system simultaneously and thus can be played via the speakers of the sound system.

Antiglare Coating to Reduce Reflection

In order to keep the map readable at anytime, the 3.5" touch screen monitor is optically coated and effectually backlit. Even in bad lighting conditions the antiglare coated display of the PN 2050 has good readability.

Planning and Simulation

Even without an active GPS signal a route can be planned and displayed. In the navigation mode the starting point is calculated automatically via GPS signal and only the destination needs to be entered into the system. Whereas independent route planning (simulation) enables selection of a simulated starting point. This feature thus provides the opportunity to calculate a route between various positions, and can be fixed at home before the start.

Safe & Easy Handling

Easy handling via touch screen functionality: the PN 2050 can be operated by one finger only. The device offers easy, simple and therefore safer handling. Easy handling of the system is achieved by a self-explanatory menu on a 3.5" touch screen and an optional wireless steering wheel remote control, which communicates via an infrared connection with the navigation device. The remote control can be clipped to the steering wheel in a few grips and therefore ensures safer driving, as hands stay on the wheel and eyes on the street.

Portable Navigation Device

PN 2050

Technical Information



Connections

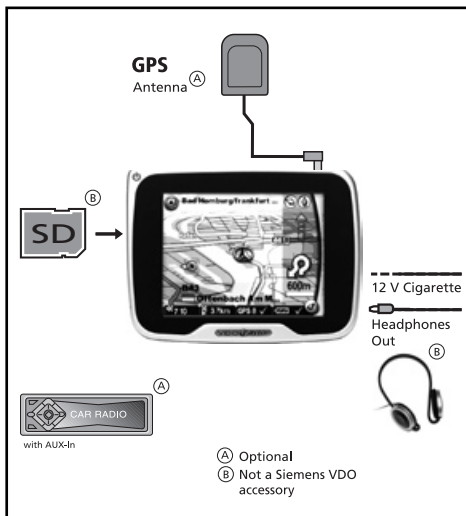

General

- Stereo Headphone Out
- IR Receiver
- Integrated GPS Antenna
- GPS Antenna IN
- Removable/ Rechargeable Li-Ion Battery
- SD Card Slot (compatible with up to 2 GB cards)

Navigation

- 3.5" Colour TFT Monitor
- Pictogram- and Voice supported Route Guidance
- 20 written menu languages (English UK, English US, Spanish, French, German, Italian, Czech, Danish, Dutch, Finnish, Hungarian, Latvian, Lithuanian, Norwegian, Polish, Portuguese, Romanian, Slovakian, Swedish, Turkish)
- 20 spoken languages (English UK, English US (2x), Spanish, French, German (2x), Italian (2x), Brasil, Czech, Danish, Dutch, Finnish, Poland, Portuguese, Russian, Slovenian, Swedish, Turkish)
- Turn-now Advices
- Route criteria:
 - Fast & Short
 - Prefer motorways
 - Avoid motorways
 - Motorbike
- Route criteria options
 - Avoid toll roads
 - Avoid ferries
 - Consider traffic information
- Position Independent Route Planning
- Northwards/Heading-Up Mode
- 2D/3D
- Auto zoom/manual zoom selectable
- Km/Miles
- Alternative Route
- Alert points (f.e. speed, traffic light cameras²)
- Freely customizable infobar (4 info fields): Time, Date, Estimated time of arrival, remaining travel time, remaining travel distance, legal speed limits, current speed, altitude above sea level, battery status, GPS status

MP3 Player

- Folder View
- Repeat Track
- Random Play
- Equalizer
- Next Track
- Next Album

JPEG Viewer

- Full Screen
- Next Picture
- Next Album
- Slide Show

Games

- Sudoku
- Block cracker

Technical Data

- 3.5" colour TFT LCD with a 320 x 240 pixel resolution, touch screen, anti-reflex surface
- 300 MHz, 64 MB Flash ROM and 64 MB SD RAM
- Integrated 12-channel GPS Receiver
- Lithium-Ion Battery 1400 mAh for up to 4h navigation
- Dimensions (w x l x d): 112mm x 77mm x 24mm
- Weight: 180 g
- Operating temperature: -20°...+60°C
- Charging temperature for Lithium-Ion Battery: 0°... +45°C
- Power Supply via:
 - Integrated rechargeable battery, 12V/24V
 - Cigarette Lighter Adaptor and
 - AC Mains Power Adaptor (100V - 240V)

Ergonomic, Safety and Ease of Use

- Antiglare Coating to reduce Reflection
- Day/Night Map View Mode
- Compatible to Steering Wheel Remote Control RCS 5100
- Automatic Display Brightness Control

Options

- TMC via MA 3000T
- Bluetooth® & TMC via MA 3000 BT

Accessories

- IR Steering Wheel Remote Control RCS 5100
- External GPS Antenna MA 2010¹

¹ The GPS signal can be blocked by heated windscreens or tinted windscreens with a vacuum-metallised surface. In this case, you might need the external GPS Antenna.

² Available in selected countries only

Please note that the PN 2050 is not waterproof.

Windows® is a registered trademark of the Microsoft® Corporation.

The Bluetooth® word mark and logos are owned by the Bluetooth® SIG, Inc. and any use of such marks by VDO Dayton is under licence. Software downloads available regularly under www.vdodayton.com

www.vdodayton.com

